

DALLAS SHOWROOM GRAND OPENING

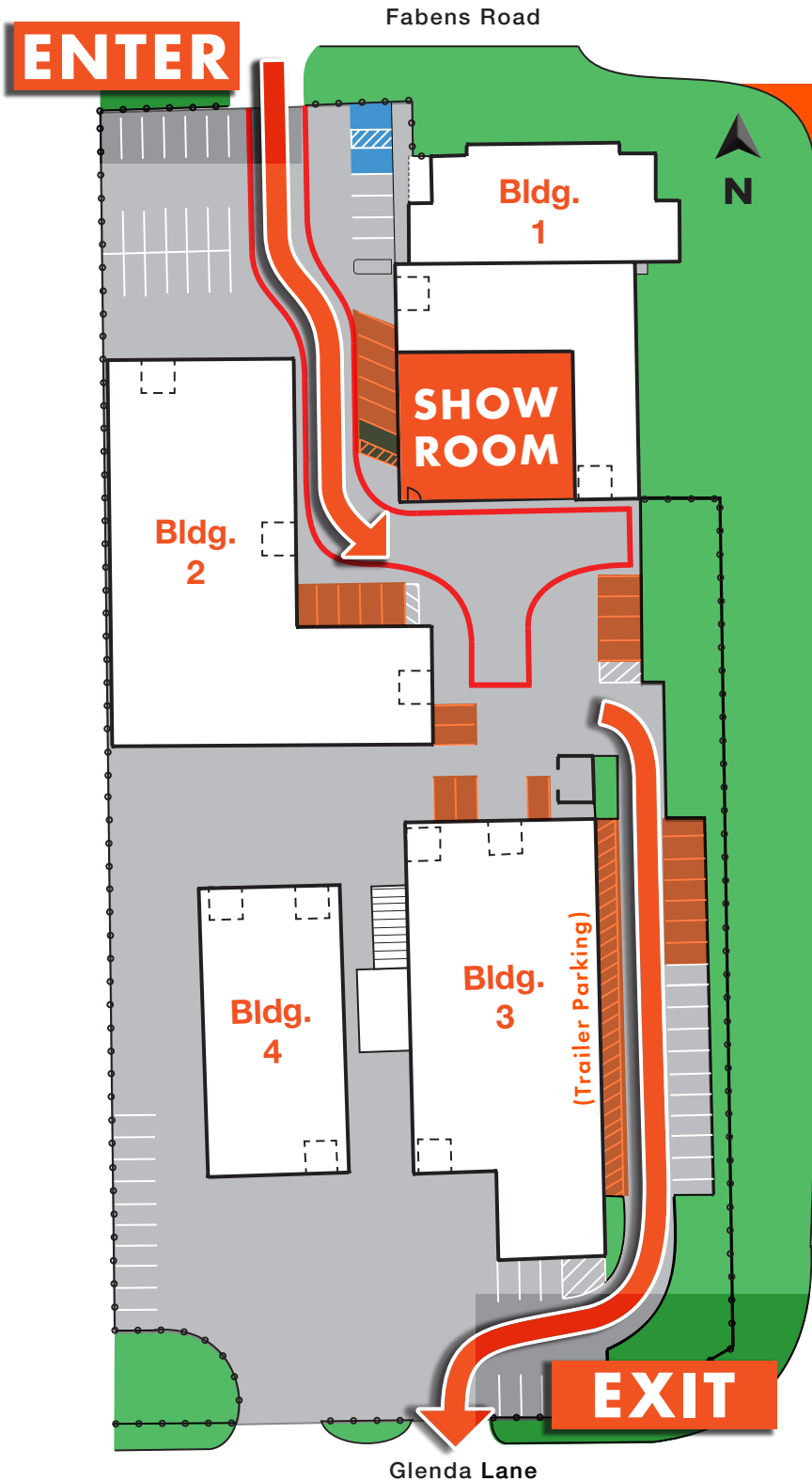

OPENING

Tuesday,
January 2nd

The new SSI Dallas sales counter/showroom will now be located in Building 1, at 11233 N. Stemmons Freeway.

All customer vehicles **MUST** enter off of Fabens Road and exit onto Glenda Lane.

The shaded areas in orange on this map represent customer parking. Please park in these designated areas.

Parking for customer vehicles with trailers is available on the East side of Building 3.

